

REVISIONS		
REV. NO.	DESCRIPTION	DATE

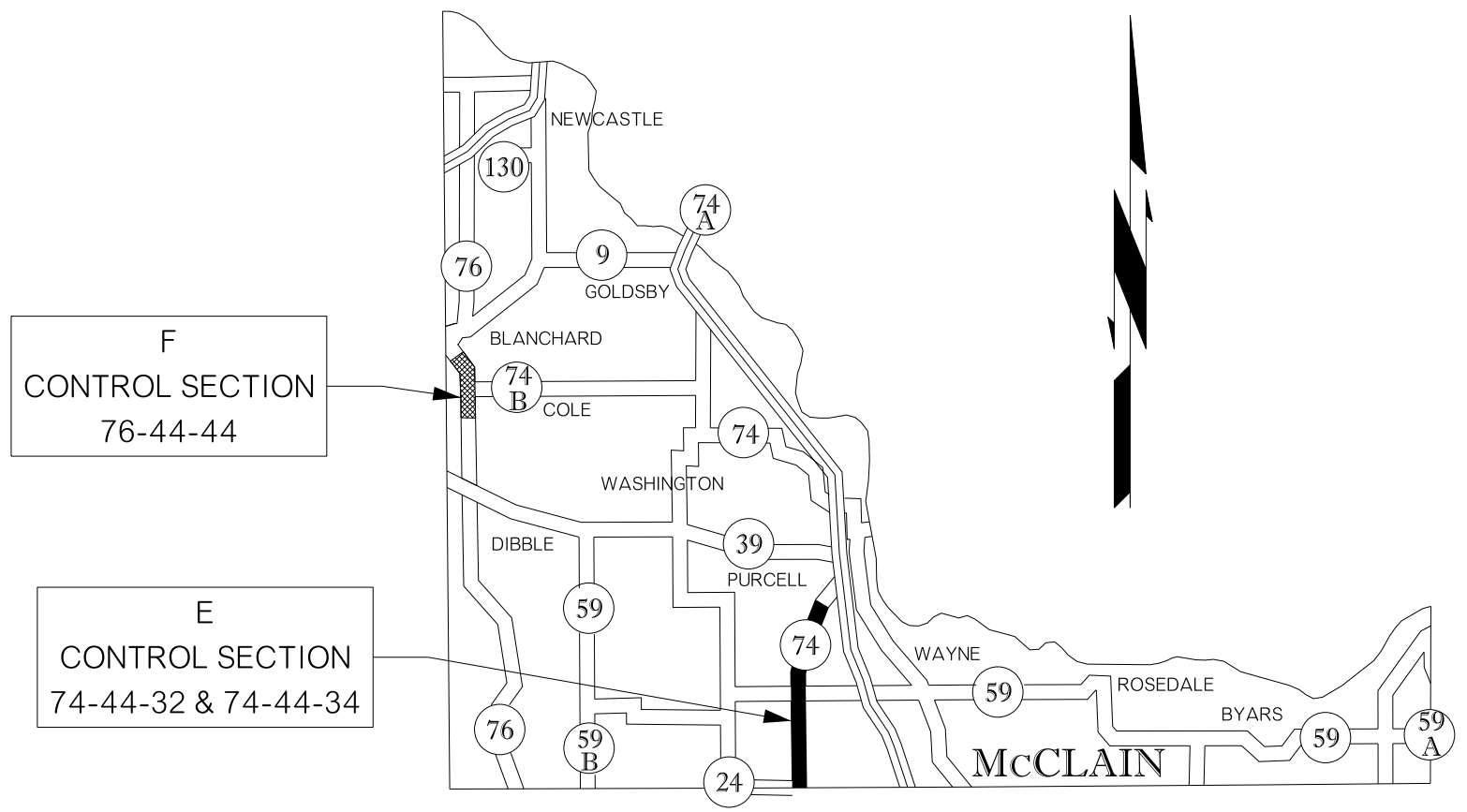

CONTROL SECTION: 74-44-32, 74-44-34 & 76-44-44		
301 TRAFFIC STRIPING		
DESCRIPTION	UNIT	QUANTITY
RUMBLE STRIP-CENTERLINE HMA-CON	LF	55,600.00
TRAFFIC STRIPE (MULTI-POLYMER)(4" WIDE)	LF	111,200.00
PAVEMENT MARKING REMOVAL (TRAFFIC STRIPE)	LF	111,200.00

PROJECT DESCRIPTION LOCATION: E SH-74: BEGINNING AT THE JUNCTION OF SH-24 AND SH-74, ON THE McCLAIN/ GARVIN COUNTY LINE, EXTENDING NORTH APPROXIMATELY 8.26 MILES TO THE CITY OF PURCELL, IN McCLAIN COUNTY.

PROJECT DESCRIPTION LOCATION: F SH-76: BEGINNING APPROXIMATELY 3.07 MILES NORTH OF THE JUNCTION OF SH-39 AND SH-76 EXTENDING NORTH APPROXIMATELY 2.27 MILES TO THE CITY OF BLANCHARD, IN McCLAIN COUNTY.

TOTAL LENGTH- 10.53 MILES

KEY:	
E:	
F:	

NOT TO SCALE

DIVISION 3 SH-74 & 76	McCLAIN COUNTY	DETAIL:	TMS	7/17
PROJECT LOCATION McCLAIN COUNTY		CHECK:	GF	7/17
		ENGINEER:	KCD	7/17
STATE OF OKLAHOMA		DEPARTMENT OF TRANSPORTATION	JOB/PIECE NO. 33294(04)	
			SHEET NO. T004	